

Presenting Limerick's Space Age City Hall

A SITE layout for Limerick's new city hall—at Charlotte Quay, across the Abbey River from Barrington's Hospital—has been prepared by a firm of consultants.

A rough estimate of the cost has already put the new building at about £850,000. It will be erected on the present car park.

Prepared by Tyndall, Hogan and Hurley, architects, the site layout—reproduced below—is planned to incorporate harmoniously:

- THE CITY Hall itself.
- A FORECOURT, landscaped public garden, and car parking.
- THE REMAINS of the town wall.
- THE RESTORATION of St. Michael's old graveyard.
- THE RE-MODELLING of Charlotte Quay and Bank Place.

Among the suggestions for the site is one advising that traffic on Charlotte Quay be reduced to a minimum, and the quay landscaped as a ceremonial mall.

The idea of locating the city hall on the quay frontage is to create "a vista between the hall itself and the Custom House by transforming Bank Place into a landscaped pedestrian space."

The city hall is recommended to reach a height of two floors, with a "semi-basement" ground floor half submerged under road level.

It is stated that the building could be ready for occupation about three years from a decision to go ahead with the project.

meeting

By 12 votes to 5, the Limerick Council of Trade Unions decided, on this Thursday night against having a public meeting—to which trade unionists in the city would be invited—to discuss the forthcoming meeting—to which trade unionists in the city would be invited—to discuss the forthcoming National Wage Agreement.

It was stated that the unions were discussing the matter themselves.

University motion

In a motion, Limerick Council of Trade Unions this week called on the Limerick University Project Committee to re-activate themselves to ensure the city got full university status.

It was said that the Minister, who made the recent announcement on status, was now thinking of postponing its fulfilment for 10 years.

College ?

The question of providing a workers' college, arose at the monthly meeting of Limerick Council of Trade Unions on this Thursday night, when delegates decided to convene a meeting with various education authorities in the city, to discuss the matter.

Underground

At this week's Limerick City Council meeting, Alderman Pat Kennedy congratulated the E.S.B. and the Corporation on the decision to put cables at Ballinacurra Gardens underground. He said work would start in two years.

One of the greatest difficulties facing gardai in detecting illegal stills, nowadays, has been the change-over by the moonshiners to bottled gas for heating the apparatus.

In the past, an experienced garda could detect the fumes from an ordinary open fire somewhere in the vicinity.

The weather, too, has been a considerable obstacle to searches, as these have to be carried out in densely-wooded areas in muddy conditions.

Torrential

The weather was not, however, a serious deterrent to the Ardnacrusha gardai when they carried out three successful raids in the past month—the last one only this week—in torrential downpours.

When they made their first raid on a still in the undergrowth, which carpets Woodcock Hill, they intercepted two men, and smashed open the steel drums containing 800 gallons of wash, and seized a quantity of the "hard stuff."

The raiding party, which was headed by Station Sergeant, Michael Solan, included Gardai Michael O'Sullivan and Denis O'Callaghan.

The apparatus was found "in full operation," chugging and bubbling away merrily in a special hide-out by the banks of a mountain stream—the water on Woodcock is good for cooling the worm and still.

Undergrowth

About only ten days later, another raid was made on the area, within only a few hundred yards of the first raid: 500 gallons of wash were seized.

Again, it was by the mountain stream, in thick undergrowth, below the level of the bank.

The captures were made "well off the road," on the way up the Windy Gap.

And this week, the third raid yielded 500 gallons of wash, worm still and apparatus, all working and puffing amid the bushes in the hide-out.

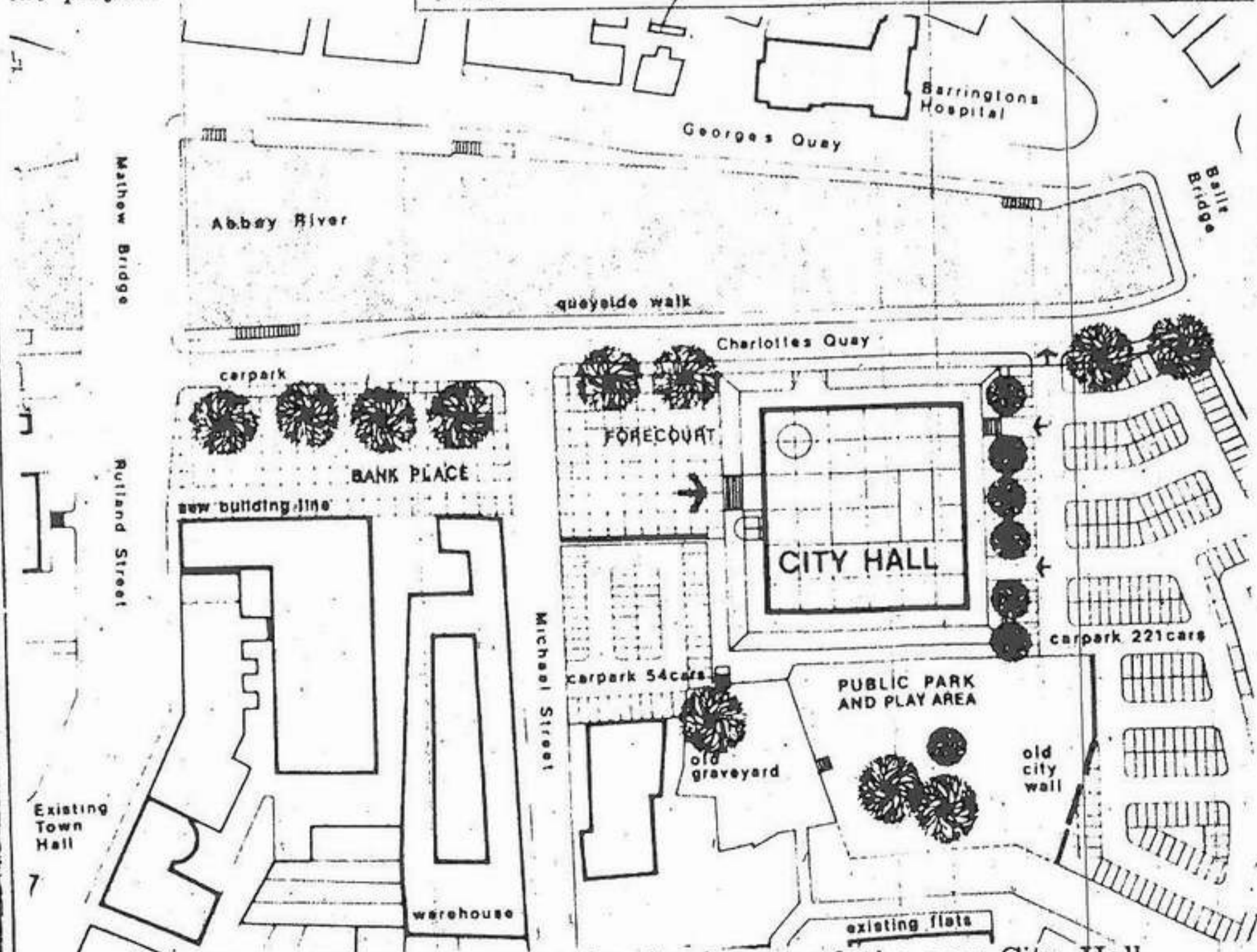

The shape of things to come: the site layout of the new City Hall.